

DETALIU / DETAIL "B"
Scara / Scale 1:10

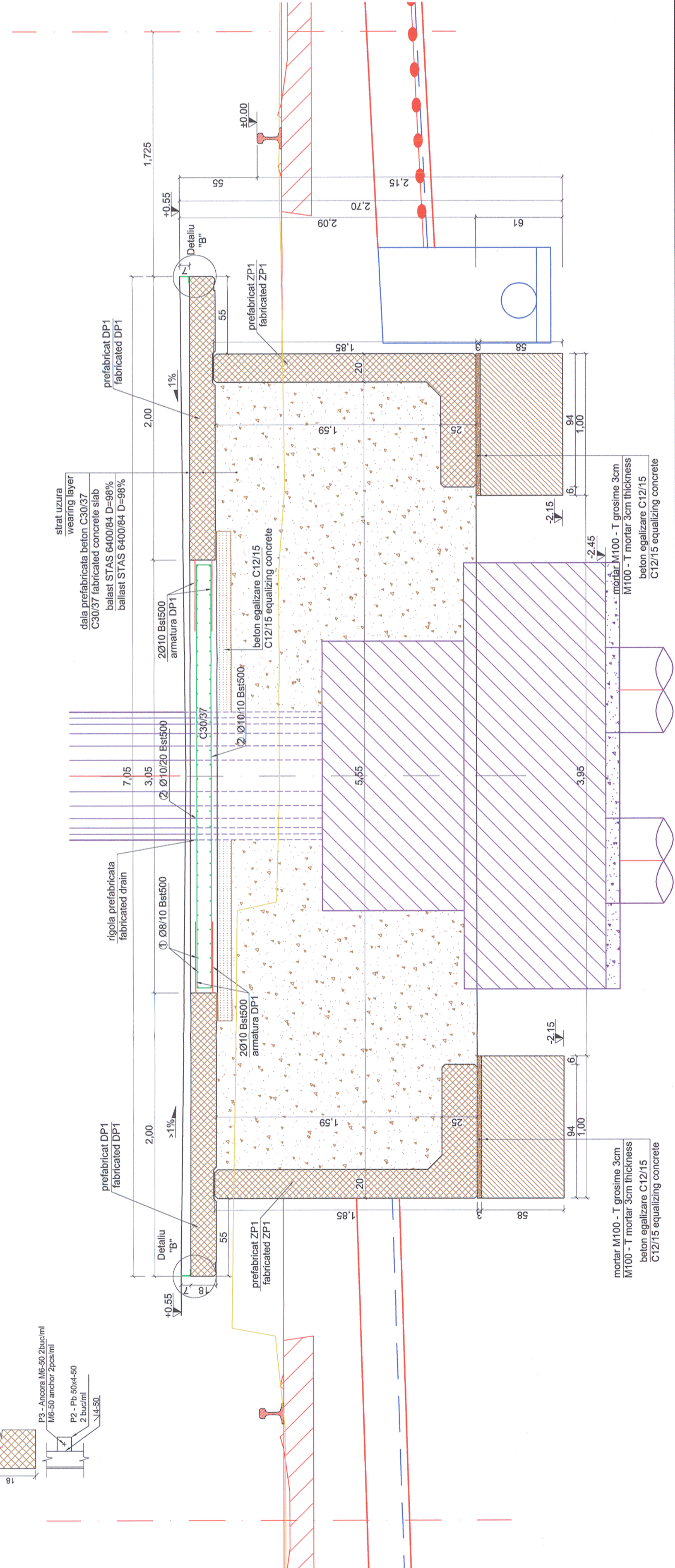
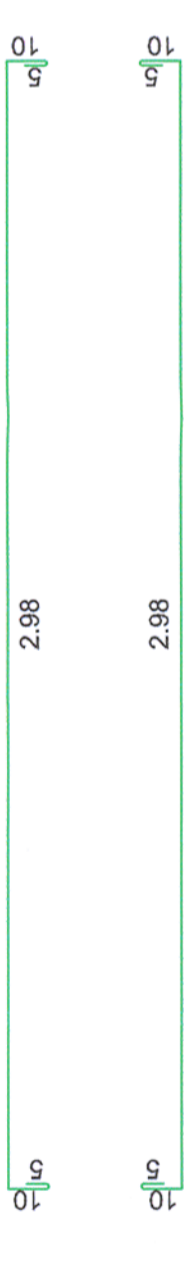

MATERIALS:

Beton de egalizare C12/15 CEM II/A-S 32.5 N ; sort 0-31; A/C : 0.75 ;
 Beton de egalizare C30/37 CEM II/A-S 42.5 N; sort 0-16; A/C : 0.55;
 Mortar M100-T
 Armatura Bst500
 Clasa de expunere: XC4 , XD3 , XF4

MATERIALS:
 Equalization concrete C12/15 CEM II/A-S 32.5 N ; sort 0-31; A/C : 0.75 ;
 Reinforced concrete C30/37 CEM II/A-S 42.5 N; sort 0-16; A/C : 0.55;
 Mortar M100-T
 Reinforcement Bst500
 Exposure class: XC4 , XD3 , XF4

Extras de laminate (pe ml de peron)/ Rolled steel extract (by ml platform)						
Pozitie/ Position	Element/ Element	Lungime / Length [m]	Bucati/ Pieces	Greutate/Weight [Kg]		Calitate / Quality
P1	L70x50x6	1.00	1	Pe U.M	Total	S255JR
P2	Pb 50x4-50	0.05	2	1.57	0.0785	S255JR
P3	M6-50	-	2	-	0.03	S255JR
Total / Total (Kg)				5.627		
Sudura / Welding (3%)				0.16881		
Greutate Totala / Total weight (Kg)				5.79581		

NOTA 1:
 In situatia demontarii prefabricatelor dinspre linie pentru executarea lucrarilor la linie cu masini grele de cale se va aplica urmatoarea tehnologie:
 1. Se demonteaza asfaltul in zona monolitizarii prefabricate (DP)
 2. Se demoleaza betonul de monolitizare.
 3. Se taie armaturile in zona centrala a monolitizarii (la min.1.50m de la marginea peronului).
 4. Se demonteaza prefabricatele si se depoziteaza in aceeaasi sectiune pe exteriorul peronului (prefabricatul demontat se depoziteaza pe cel care nu se demonteaza).
 5. Se executa lucrările la cale.
 6. Se reface peronul prin montarea prefabricatelor pe pozitia initiala.
 7. Pe masura ce se monteaza elementele prefabricate de peron se asigura continuitatea armaturilor. Taiate in faza 3 , cu eclise din Bst500 Ø10mm l=250mm sudate.
 8. Se monolitizeaza cu beton C30/37 zona demolata si se reface asfaltul decoperat.

NOTE 1:
 The following technology will be applied in case when the prefabricated elements from the line will be removed in order to execute the line works with heavy track machines:
 1. the asphalt uncovering in the concrete cast in position area between prefabricated elements (DP)
 2. removing the cast-in-place concrete
 3. cutting the reinforcements in the central area of the concrete cast in position (at min.1.50 m from the platform edge)
 4. removing the prefabricated elements and storing them in the same section on the platform exterior side (the removed prefabricated unit is stored on the one which is not removed)
 5. track works execution
 6. renewing the platform by mounting prefabricated elements on the initial position
 7. while mounting the prefabricated elements on the platform it is ensured the continuity of reinforcement that were cut at point 3, by help of Bst500 welded fishplates having Ø 10mm and l = 250 mm
 8. the removed area is casted-in-place with concrete C 30/37 and the uncovered asphalt is renewed.

Extras de armatura / Reinforcement extract

Element	Marca/ Mark	Diametru/ Diameter (mm)	Nr. Buc. No. of pieces	Lungime/ Length (m)	Bst500 (S500)	
					φ 8	φ 10
1		8	62	1.00	62.00	
2		10	10	3.28		32.80
Lungime totala pe diametre / Total length on diameter (m)					62.00	32.80
Masa pe metru /Mass on meter (kg/m)					0.395	0.617
Masa pe diametre / Mass on diameter (kg)					24.49	20.24
Masa totala pe tip de otel / Total mass on steel type (kg)					45.00	

CLASA DE IMPORTANTA A CONSTRUCTIEI
 CONFORM P100/1-2006 ESTE III;CATEGORIA DE
 IMPORTANTA CONFORM H.G. nr. 766/97 este "C".
 THE CONSTRUCTION IMPORTANCE CLASS,
 ACCORDING TO P100/1-2006, IS III;
 CATEGORY, ACCORDING TO H.G. 766/97 IS "C"

Acest plan anuleaza si inlocuieste planul nr. PT.03.03.26.RE.01.006 elaborat la data 01.2013.

This layout plan canceled and replaced layout plan no. PT.03.03.26.RE.01.006 prepared on 01.2013.

Logo: European Investment Bank

Logo: MINISTERUL TRANSPORTURILOR

Logo: COMPANIA NATIONALA DE CAI FERATE "CFR" SA

Logo: PÖYRY

Logo: VIOTOP

Logo: European Union

Verificator / Expert Checker / Expert	Cerinta Requirement	Semnatura Signature	Referat / Expertiza Report / Expertise
PROIECTANT / DESIGNER:		Semnatura Signature	
		Date Date	
Approbat Approved	Şef de echipă Team leader	01.2013	
Verificat Expert	Expert Cheile		
Checkat Key Expert	R. Witan	01.2013	
Subcontractant / Subcontractor			
Aprobat Approved		A.M. Baicu	
Proiectat Designed		D.Oprescu	
Denumire desen / Drawing name:		Project 91 353317.1	
		Pan - European pentru circuita 7a trenurilor cu viteza maxima de 160 km/h"	
		Tronsoanel 3: Gurasada - Simeria	
		"Rehabilitarea liniei c.f. Frontier a - Curtici - Simeria , componenta a coridorului IV	
		Pan - European Corridor for the Trains Circulation with maximum speed of 160 km/h"	
		Section 3: Gurasada - Simeria	
		PTh+CS / TD+TS	
Scara / Scale		Revizia / Revision	Cod desen / Drawing Code
1:10 ; 1:20	1/05.2013		PT.03.03.26.RE.01.006
		Nr / No	
		06/08	